

## Parks, Trails, & Open Space

---

### Funded Projects

#### *Overview*

The Parks, Trails & Open Space Capital Improvement Program provides for the planning, design and construction of projects that include open space and park site land acquisition and park, trail and greenway development.

#### *Highlights*

1. Gradin Sports Park Development #CIPPK00001 designs and constructs additional softball/Little League baseball or soccer fields, a concession/restroom building and other associated amenities.
2. Park Master Plan Update and Concept Planning for Undeveloped Parks #CIPPK00004 will update the City's 2009 Parks and Recreation, Trails and Natural Areas Master Plan and/or develop concept plans for undeveloped parks within the City's park system.
3. Metro Local Share Park Improvements #CIPPK00006 will plan, design, and construct park or trail improvements and amenities associated with Gresham's "Local Share" component of Metro's 2019 Parks and Natural Areas bond measure.
4. Main City Park playground improvements #CIPPK00009 will construct accessible and inclusive amenities to be enjoyed by everyone of all ages and abilities. This project is contingent on successful award of a 2026 Congressionally Directed Spending grant.
5. Additional Parks projects are included in the General Development section of the CIP.

### Parks, Trails, & Open Space Expenditure Graph by Fiscal Year

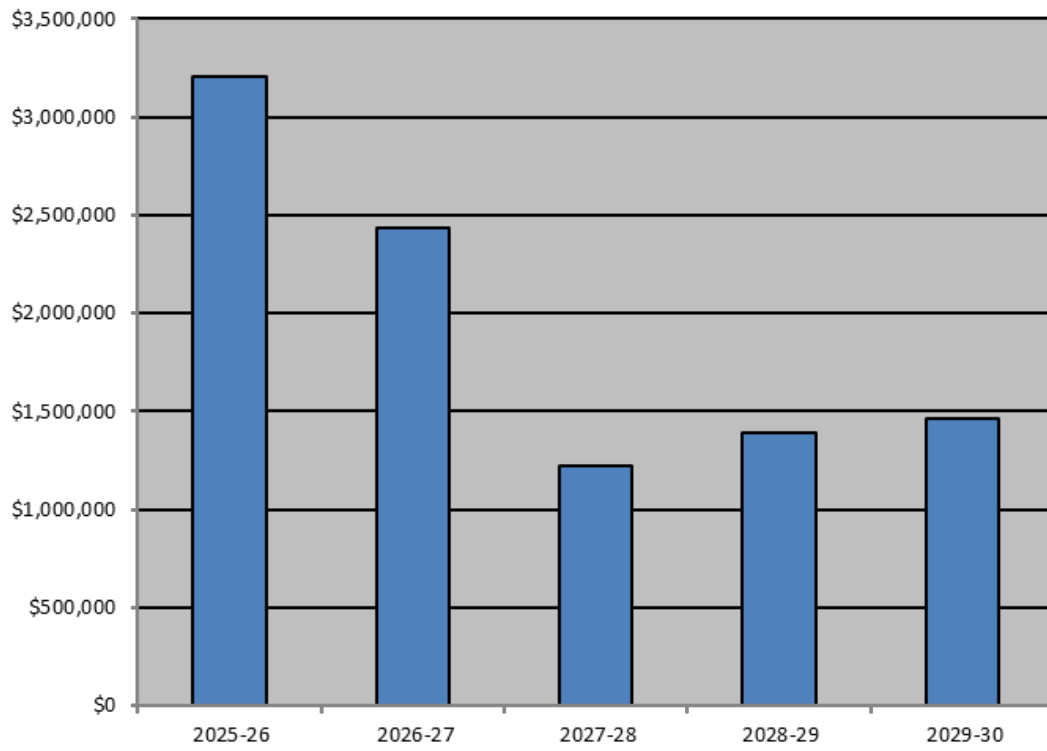

Parks, Trails, & Open Space Funded Summary									
Project	Project Name	2024-25	2025-26	2026-27	2027-28	2028-29	2029-30	Total	
CIPPK00001	Gradin Sports Park Development	11,934,051	0	0	0	0	0	11,934,051	
CIPPK00003	Development Coordination Projects	75,000	0	0	0	0	0	75,000	
CIPPK00004	Park Master Plan Update and Concept Planning for Undev	250,674	0	0	0	0	0	250,674	
CIPPK00006	Metro Local Share Park Improvements	1,577,646	1,737,749	964,513	1,222,749	1,387,285	1,460,481	8,350,423	
CIPPK00007	ARPA/City of Gresham Investments	674,314	0	0	0	0	0	674,314	
CIPPK00008	Civic Neighborhood Park Phase 1	2,881,303	0	0	0	0	0	2,881,303	
CIPPK00009	Main City Park Playground Improvements	0	1,467,500	1,467,500	0	0	0	2,935,000	
<b>Grand Total</b>		<b>17,392,988</b>	<b>3,205,249</b>	<b>2,432,013</b>	<b>1,222,749</b>	<b>1,387,285</b>	<b>1,460,481</b>	<b>27,100,765</b>	

Parks, Trails, & Open Space Funded Summary by Resource								
Description	2024-25	2025-26	2026-27	2027-28	2028-29	2029-30	Total	
Other	451,012	37,500	37,500	0	0	0	526,012	
Dev/SDC Credit	2,956,303	0	0	0	0	0	2,956,303	
Grant	8,788,076	1,000,000	1,000,000	0	0	0	10,788,076	
IGA	0	450,000	500,000	720,000	1,100,000	850,000	3,620,000	
SDC	5,197,597	1,717,749	894,513	502,749	287,285	610,481	9,210,374	
<b>Grand Total</b>	<b>17,392,988</b>	<b>3,205,249</b>	<b>2,432,013</b>	<b>1,222,749</b>	<b>1,387,285</b>	<b>1,460,481</b>	<b>27,100,765</b>	

Parks, Trails, & Open Space Funded Resource Detail									
Project	Project Name	Description	2024-25	2025-26	2026-27	2027-28	2028-29	2029-30	Total
CIPPK00001	Gradin Sports Park Development	Grant	6,770,116	0	0	0	0	0	6,770,116
		Other	150,000	0	0	0	0	0	150,000
		SDC	5,013,935	0	0	0	0	0	5,013,935
CIPPK00001 Total		11,934,051	0	0	0	0	0	0	11,934,051
CIPPK00003	Development Coordination Projects	Dev/SDC Credit	75,000	0	0	0	0	0	75,000
CIPPK00003 Total			75,000	0	0	0	0	0	75,000
CIPPK00004	Park Master Plan Update and Concept Planning for Umr	Other	167,012	0	0	0	0	0	167,012
		SDC	83,662	0	0	0	0	0	83,662
CIPPK00004 Total			250,674	0	0	0	0	0	250,674
CIPPK00006	Metro Local Share Park Improvements	Grant	1,402,646	0	0	0	0	0	1,402,646
		IGA	0	450,000	500,000	720,000	1,100,000	850,000	3,620,000
		Other	75,000	0	0	0	0	0	75,000
		SDC	100,000	1,287,749	464,513	502,749	287,285	610,481	3,252,777
CIPPK00006 Total			1,577,646	1,737,749	964,513	1,222,749	1,387,285	1,460,481	8,350,423
CIPPK00007	ARPA/City of Gresham Investments	Grant	615,314	0	0	0	0	0	615,314
		Other	59,000	0	0	0	0	0	59,000
CIPPK00007 Total			674,314	0	0	0	0	0	674,314
CIPPK00008	Civic Neighborhood Park Phase 1	Dev/SDC Credit	2,881,303	0	0	0	0	0	2,881,303
CIPPK00008 Total			2,881,303	0	0	0	0	0	2,881,303
CIPPK00009	Main City Park Playground Improvements	Grant	0	1,000,000	1,000,000	0	0	0	2,000,000
		Other	0	37,500	37,500	0	0	0	75,000
		SDC	0	430,000	430,000	0	0	0	860,000
CIPPK00009 Total			0	1,467,500	1,467,500	0	0	0	2,935,000
Grand Total			17,392,988	3,205,249	2,432,013	1,222,749	1,387,285	1,460,481	27,100,765



**FUNDED PROJECT**  
**Parks, Trails, & Open Space**

**CIPPK00001: Gradin Sports Park Development**

**Description:** This project will design and build additional improvements and amenities associated with the Master Plan for the Gradin Community Sports Park in south Gresham. The project is located in the Hogan Cedars Neighborhood. This project will construct additional softball/Little League baseball and soccer fields, restroom facilities, parking, street frontage, and other amenities needed for a tournament-quality facility. There are four awarded grants: 1) \$2,000,000 from the Oregon State Lottery Bond, 2) \$2,000,000 from the federal Consolidated Appropriations Act of 2022, 3) \$2,000,000 from the American Rescue Plan Act, and 4) \$467,950 from the Local Government Grant Program administered by Oregon State Parks. Other funds of \$150,000 in sports field fees will also be used. This project is related to #723400. SDC project #20.

**Justification:** This multi-use sports complex is needed to help meet the recreation and service needs of the community.

**Type of Project:** Design and construction of new community park amenities.

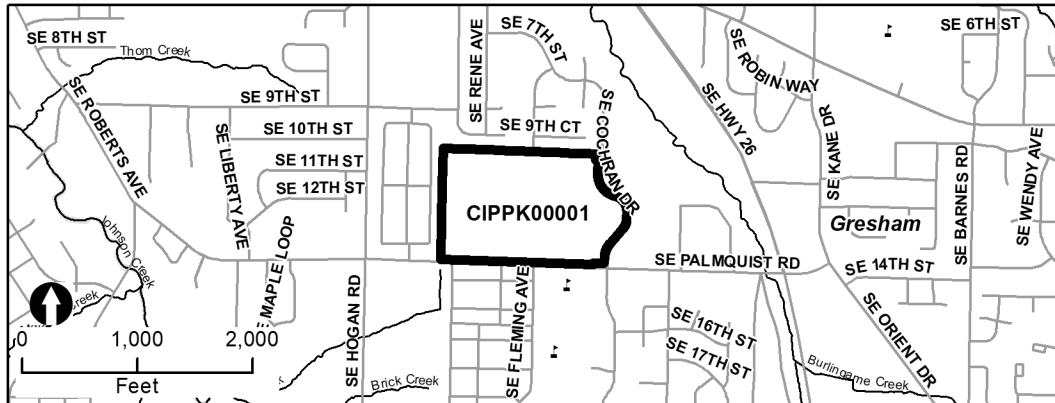

**Estimated Dollars:**

Funds	Description	2024-25	2025-26	2026-27	2027-28	2028-29	2029-30	Total
<b>Resources</b>	Other	150,000	0	0	0	0	0	150,000
	Grant	6,770,116	0	0	0	0	0	6,770,116
	SDC	5,013,935	0	0	0	0	0	5,013,935
<b>Resources Total</b>		<b>11,934,051</b>	<b>0</b>	<b>0</b>	<b>0</b>	<b>0</b>	<b>0</b>	<b>11,934,051</b>
<b>Expenses</b>	Design/Const Admin	300,000	0	0	0	0	0	300,000
	Construction	10,168,451	0	0	0	0	0	10,168,451
	Admin (14%)	1,465,600	0	0	0	0	0	1,465,600
<b>Expenses Total</b>		<b>11,934,051</b>	<b>0</b>	<b>0</b>	<b>0</b>	<b>0</b>	<b>0</b>	<b>11,934,051</b>

**FUNDED PROJECT**  
**Parks, Trails, & Open Space**

**CIPPK00003: Development Coordination Projects**

**Description:** This project funding will be used to leverage park revenue with new development projects or other projects resulting in park and path/trail improvements beyond what either the new development or City resources could have accomplished alone. This project may provide systems development charge credits to developers for certain identified improvements.

**Justification:** Development projects often trigger a need for certain improvements that are not within the scope of the project, but need to be done to accommodate the park and path/trail impacts. This project creates a funding base to complement the developer's contribution and to accomplish needed improvements.

**Type of Project:** Construction of facilities and utilities for growth.



**Estimated Dollars:**

Funds	Description	2024-25	2025-26	2026-27	2027-28	2028-29	2029-30	Total
Resources	Dev/SDC Credit	75,000	0	0	0	0	0	75,000
Resources Total		75,000	0	0	0	0	0	75,000
Expenses	Construct/Reimburse	75,000	0	0	0	0	0	75,000
Expenses Total		75,000	0	0	0	0	0	75,000



**FUNDED PROJECT**  
**Parks, Trails, & Open Space**

**CIPPK00004: Park Master Plan Update and Concept Planning for Undeveloped Parks**

**Description:** This project will update the City's 2009 Parks and Recreation, Trails and Natural Areas Master Plan and/or develop concept plans for undeveloped parks within the City's park system.

**Justification:** The City's Parks and Recreation, Trails and Natural Areas Master Plan is over 10 years old and needs to be updated to reflect the process made since 2009 and accurately depict the community's desires for the buildout of the remaining park system in Gresham. Concept plans will identify park amenities and costs for the development of a wide range of active and passive recreation opportunities within the 6 undeveloped park sites in Gresham.

**Type of Project:** Master planning and concept planning for growth of the parks system.

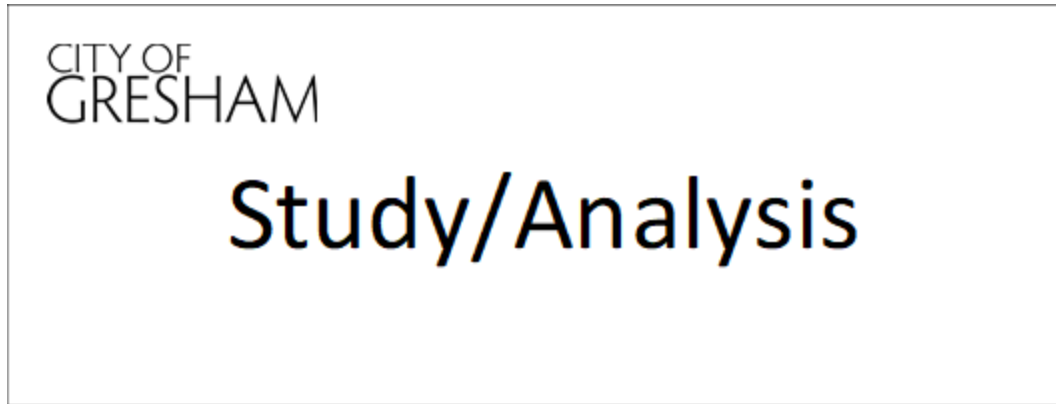

**Estimated Dollars:**

Funds	Description	2024-25	2025-26	2026-27	2027-28	2028-29	2029-30	Total
Resources	Other	167,012	0	0	0	0	0	167,012
	SDC	83,662	0	0	0	0	0	83,662
Resources Total		250,674	0	0	0	0	0	250,674
Expenses	Design/Const Admin	219,874	0	0	0	0	0	219,874
	Admin (14%)	30,800	0	0	0	0	0	30,800
Expenses Total		250,674	0	0	0	0	0	250,674

**FUNDED PROJECT**  
**Parks, Trails, & Open Space**

**CIPPK00006: Metro Local Share Park Improvements**

**Description:** This project will plan, design, and construct park or trail improvements and amenities associated with Gresham's "Local Share" component of Metro's 2019 Parks and Natural Areas bond measure. This project will be associated with an IGA between Metro and the City of Gresham that will specify the projects the City of Gresham will construct with its Local Share dollars from the bond. A grant of \$420,000 from the American Rescue Plan Act has been awarded. Another grant of \$982,646 from the Local Government Grant Program administered by Oregon State Parks has been awarded for improving the SW Community Park. Additional funding is still needed to complete planned improvements and additional grant opportunities are being explored.

**Justification:** This project will help provide access to nature for the community.

**Type of Project:** Design and construction of new park or trail amenities.



**Estimated Dollars:**

Funds	Description	2024-25	2025-26	2026-27	2027-28	2028-29	2029-30	Total
Resources	Other	75,000	0	0	0	0	0	75,000
	Grant	1,402,646	0	0	0	0	0	1,402,646
	IGA	0	450,000	500,000	720,000	1,100,000	850,000	3,620,000
	SDC	100,000	1,287,749	464,513	502,749	287,285	610,481	3,252,777
Resources Total		1,577,646	1,737,749	964,513	1,222,749	1,387,285	1,460,481	8,350,423
Expenses	Design/Const Admin	500,000	150,000	200,000	200,000	200,000	200,000	1,450,000
	Construction	1,031,646	1,537,149	736,413	987,149	1,146,885	1,217,981	6,657,223
	Admin (3%)	46,000	50,600	28,100	35,600	40,400	42,500	243,200
Expenses Total		1,577,646	1,737,749	964,513	1,222,749	1,387,285	1,460,481	8,350,423

**FUNDED PROJECT**  
**Parks, Trails, & Open Space**

**CIPPK00007: ARPA/City of Gresham Investments**

**Description:** This project will use funds from the American Rescue Plan Act of 2021 to invest in Qualified Census Tract areas to, 1) construct a multi-sport surface and renovate a basketball surface in West Gresham, and, if construction bids are favorable, renovate basketball and tennis courts at other Gresham parks, 2) complete the Americans with Disabilities Act (ADA) capital assessment of all Gresham parks and construct the first fully ADA accessible playground infrastructure in Gresham, and 3) construct, in partnership with a community-based organization, a new community garden in the Rockwood neighborhood.

**Justification:** These investments address health disparities and the social determinants of health by promoting healthier living environments and outdoor recreation and socialization to mitigate the spread of COVID-19 and increase food security in an area that has lacked fresh, healthy options.

**Type of Project:** Construction and renovation of neighborhood park facilities.



**Estimated Dollars:**

Funds	Description	2024-25	2025-26	2026-27	2027-28	2028-29	2029-30	Total
Resources	Other	59,000	0	0	0	0	0	59,000
	Grant	615,314	0	0	0	0	0	615,314
Resources Total		674,314	0	0	0	0	0	674,314
Expenses	Design/Const Admin	50,000	0	0	0	0	0	50,000
	Construction	567,614	0	0	0	0	0	567,614
	Admin (14%)	56,700	0	0	0	0	0	56,700
Expenses Total		674,314	0	0	0	0	0	674,314

**FUNDED PROJECT**  
Parks, Trails, & Open Space

**CIPPK00008: Civic Neighborhood Park Phase 1**

**Description:** This project reflects the City's potential obligation to reimburse a developer for construction of park infrastructure related to the Civic Neighborhood Plan Area. The project is located in the Northwest Neighborhood District. This project is related to #CIPPK00005 and #725000. SDC project #65.

**Justification:** Development is needed to provide a wide range of active and passive recreation opportunities for citizens at their nearby neighborhood park.

**Type of Project:** Design and/or construction of neighborhood park facilities for growth.

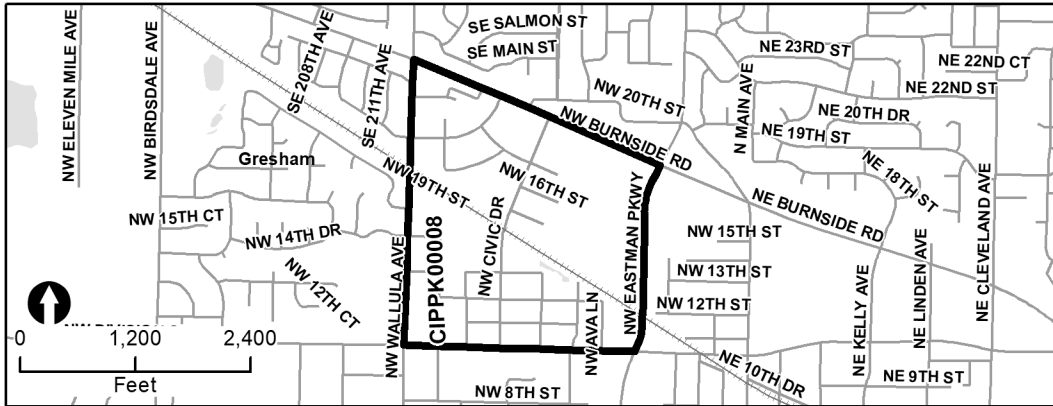

**Estimated Dollars:**

Funds	Description	2024-25	2025-26	2026-27	2027-28	2028-29	2029-30	Total
Resources	Dev/SDC Credit	2,881,303	0	0	0	0	0	2,881,303
<b>Resources Total</b>		<b>2,881,303</b>	<b>0</b>	<b>0</b>	<b>0</b>	<b>0</b>	<b>0</b>	<b>2,881,303</b>
Expenses	Construct/Reimburse	2,881,303	0	0	0	0	0	2,881,303
<b>Expenses Total</b>		<b>2,881,303</b>	<b>0</b>	<b>0</b>	<b>0</b>	<b>0</b>	<b>0</b>	<b>2,881,303</b>

**FUNDED PROJECT**  
**Parks, Trails, & Open Space**

**CIPPK00009: Main City Park Playground Improvements**

**Description:** When completed, this will be the City’s first fully inclusive and accessible playground. The objective is to provide more equitable access to parks for an increasingly diverse, young, and economically challenged population while also providing long-term economic benefits to the Gresham community. Improvements will fulfil the vision for a “destination playground” that would serve Gresham residents while attracting visitors from around the region. Main City Park is located in the Central City and Gresham Butte Neighborhood Districts. SDC project #67.

**Justification:** This all inclusive and accessible playground is needed to help the recreation and service needs of the community.

**Type of Project:** Design and construction of new community park amenities.



**Estimated Dollars:**

Funds	Description	2024-25	2025-26	2026-27	2027-28	2028-29	2029-30	Total
<b>Resources</b>	Other	0	37,500	37,500	0	0	0	75,000
	Grant	0	1,000,000	1,000,000	0	0	0	2,000,000
	SDC	0	430,000	430,000	0	0	0	860,000
<b>Resources Total</b>		<b>0</b>	<b>1,467,500</b>	<b>1,467,500</b>	<b>0</b>	<b>0</b>	<b>0</b>	<b>2,935,000</b>
<b>Expenses</b>	Design/Const Admin	0	150,000	75,000	0	0	0	225,000
	Construction	0	1,137,300	1,212,300	0	0	0	2,349,600
	Admin (14%)	0	180,200	180,200	0	0	0	360,400
<b>Expenses Total</b>		<b>0</b>	<b>1,467,500</b>	<b>1,467,500</b>	<b>0</b>	<b>0</b>	<b>0</b>	<b>2,935,000</b>



Parks, Trails, & Open Space Unfunded and Future Summary									
Project	Project Name	2024-25	2025-26	2026-27	2027-28	2028-29	2029-30	Total	
703200	SE Community Park Master Plan	0	0	0	0	0	0	110,876	
705000	SW Community Park Development	0	0	0	0	0	0	17,246,057	
707800	Pat Pfeifer Park Phase III	0	0	0	0	0	0	3,527,667	
710900	Southwest Neighborhood Park	0	0	0	0	0	0	3,538,159	
711200	ADA Accessibility Rehabilitation	0	0	0	0	0	0	184,679	
711900	Zimmerman Heritage Farm Community Park	0	0	0	0	0	0	3,916,303	
713700	South Central Neighborhood Park Dev.	0	0	0	0	0	0	3,114,575	
715800	East Gresham Neighborhood Park	0	0	0	0	0	0	3,713,252	
722000	SW Community Park Master Plan	0	0	0	0	0	0	110,876	
722100	Southeast Neighborhood Park	0	0	0	0	0	0	4,363,580	
722200	Jenne Butte Neighborhood Park Master Plan	0	0	0	0	0	0	84,292	
722300	Jenne Butte Neighborhood Park Development	0	0	0	0	0	0	4,408,480	
722400	Downtown Neighborhood Park #1	0	0	0	0	0	0	4,246,984	
722500	Gresham Paths	0	0	0	0	0	0	2,468,346	
722501	Gresham Soft Trails	0	0	0	0	0	0	10,971,812	
722600	Rockwood Neighborhood Park	0	0	0	0	0	0	3,468,910	
722700	Pat Pfeifer Park Irrigation	0	0	0	0	0	0	50,000	
723300	Skate Park Future Phases	0	0	0	0	0	0	2,280,000	
723400	Sports Park Development	0	0	0	0	0	0	34,326,257	
723500	Arts Center	0	0	0	0	0	0	16,480,000	
723600	SE Community Park Development	0	0	0	0	0	0	9,527,938	
723700	Main City Park Improvements Future	0	0	0	0	0	0	9,718,415	
723800	Hogan Butte Nature Park Development - Phase 2	0	0	0	0	0	0	3,890,428	
724800	Nadaka Nature Park	0	0	0	0	0	0	38,904	
724900	Columbia View Neighborhood Park	0	0	0	0	0	0	4,963,847	
725000	Civic Neighborhood Park Phase 2	0	0	0	0	0	0	4,246,984	
725100	Rockwood Soccer/Futsal Courts	0	0	0	0	0	0	207,487	
725200	Downtown Neighborhood Park #2 - East	0	0	0	0	0	0	4,246,984	
CIPPK00002	Vance Neighborhood Park	0	0	0	0	0	0	713,234	
CIPPK00005	Civic Neighborhood Development - 1996 Agreement	0	0	0	0	0	0	799,700	
<b>Grand Total</b>		<b>0</b>	<b>0</b>	<b>0</b>	<b>0</b>	<b>0</b>	<b>0</b>	<b>156,965,026</b>	





**UNFUNDED and FUTURE PROJECT**  
**Parks, Trails, & Open Space**

**703200: SE Community Park Master Plan**

**Description:** This project will complete the master planning and design for the 16.13-acre, undeveloped community park site in southeast Gresham. The project is located in the Kelly Creek Neighborhood District. This project is related to #723600. SDC project #4.

**Justification:** The master plan will identify park amenities and costs for the development of a wide range of active and passive recreation opportunities for all Gresham residents.

**Type of project:** Master planning and design of a community park for growth.

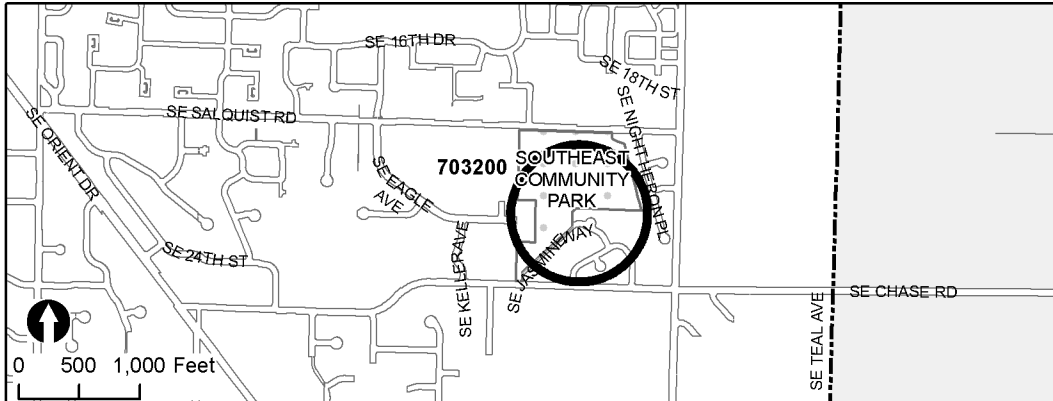

**Estimated Dollars:**

Funds	Description	Total
<b>Resources</b>	Other	61,987
	SDC	48,889
<b>Resources Total</b>		<b>110,876</b>
<b>Expenses</b>	Design/Const Admi	97,260
	Admin (14%)	13,616
<b>Expenses Total</b>		<b>110,876</b>

**UNFUNDED and FUTURE PROJECT**  
**Parks, Trails, & Open Space**

**705000: SW Community Park Development**

**Description:** This project will construct recreation facilities identified in the master plan for the 34.11-acre undeveloped community park in southwest Gresham. The project is located in the Centennial Neighborhood District. This project is related to #722000. SDC project #5.

**Justification:** Development is needed to provide a wide range of active and passive recreation opportunities for all Gresham residents, such as natural areas, performance spaces, playing fields for organized sports, trails, and group picnic areas.

**Type of Project:** Construction of facilities and utilities for growth.

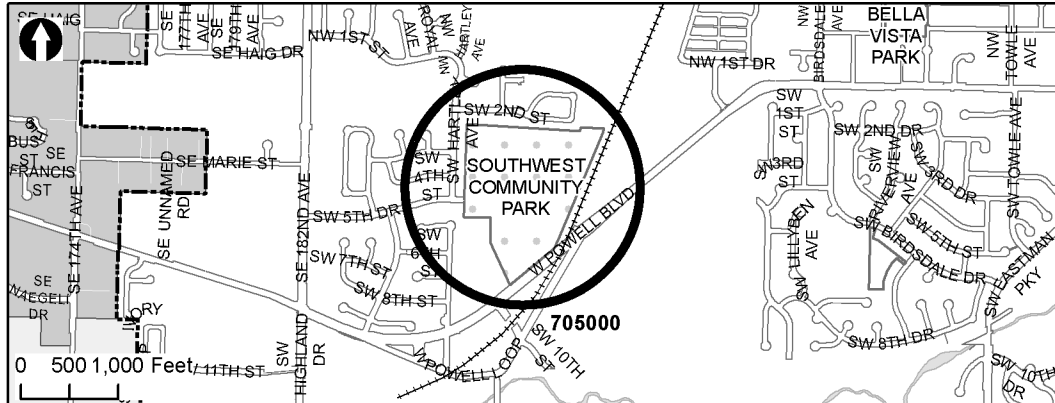

**Estimated Dollars:**

Funds	Description	Total
<b>Resources</b>	Other	9,650,064
	SDC	7,595,993
<b>Resources Total</b>		<b>17,246,057</b>
<b>Expenses</b>	Design/Const Admi	454,203
	Construction	14,673,918
	Admin (14%)	2,117,936
<b>Expenses Total</b>		<b>17,246,057</b>

## 707800: Pat Pfeifer Park Phase III

**Type of Project:** Construction of additional park facilities at a partially developed community park for growth.

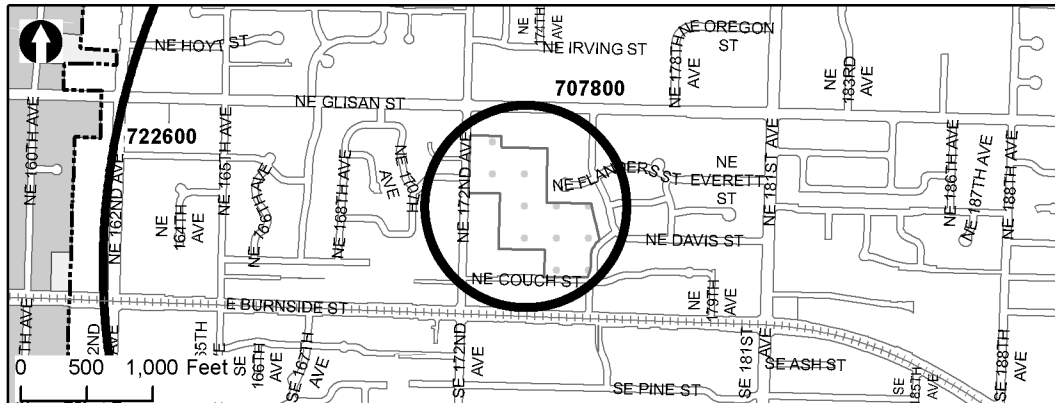

Funds	Description	Total
Resources	Other	1,973,902
	SDC	1,553,765
Resources Total		3,527,667
Expenses	Design/Const Admi	551,462
	Construction	2,542,983
	Admin (14%)	433,222
Expenses Total		3,527,667



**UNFUNDED and FUTURE PROJECT  
Parks, Trails, & Open Space**

**711200: ADA Accessibility Rehabilitation**

**Description:** This project will renovate existing park, trail and open space facilities to meet the federally mandated Americans with Disabilities Act of 1992 (ADA) requirements. The required access route, curb, ramp, handrail, signage, parking, playground, drinking fountain, and picnic table improvements will be constructed to provide the community with accessible recreation opportunities for all age groups. Renovations to meet ADA requirements will occur at the following parks: Aspen Highlands, Bella Vista, Butler Creek, Columbia View, Davis, Hall, Kane Road, Kirk, North Gresham, Pat Pfeifer, Rockwood Central and Thom Park. Renovations will also occur along the Butler Creek Greenway trail and the Springwater Trail. This project is related to #707800 and #724900.

**Justification:** The City has been mandated to provide accessible recreation opportunities for people with disabilities.

**Type of Project:** Repair and rehabilitation of facilities in various parks.



Estimated Dollars:	Funds	Description	Total
	Resources	Grant	100,000
		Operating	84,679
	Resources Total		184,679
	Expenses	Design/Const Admin	20,000
		Construction	141,999
		Admin (14%)	22,680
	Expenses Total		184,679

**UNFUNDED and FUTURE PROJECT**  
**Parks, Trails, & Open Space**

**711900: Zimmerman Heritage Farm Community Park**

**Description:** This project will design and construct community park facilities on this 5.97 acre historic property. The project will be in cooperation with the Multnomah County Historic Society, who owns the Zimmerman House, while the City of Gresham owns the underlying property. The Zimmerman Heritage Farm master plan was adopted in 1988 and may require an update. The project is located in the Wilkes East Neighborhood District. SDC project #8.

**Justification:** The project will provide passive recreation facilities and educational opportunities for the community to learn about Gresham's history of agriculture.

**Type of Project:** Construction of additional park facilities at a partially developed community park for growth.

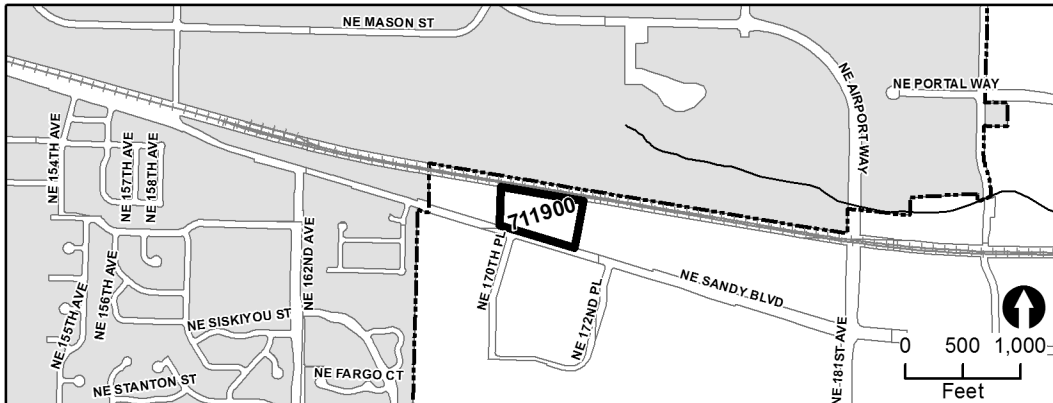

**Estimated Dollars:**

Funds	Description	Total
<b>Resources</b>	Other	2,191,362
	SDC	1,724,941
<b>Resources Total</b>		<b>3,916,303</b>
<b>Expenses</b>	Design/Const Admi	85,314
	Construction	3,350,040
	Admin (14%)	480,949
<b>Expenses Total</b>		<b>3,916,303</b>

**UNFUNDED and FUTURE PROJECT**  
**Parks, Trails, & Open Space**

**713700: South Central Neighborhood Park Development**

**Description:** This project will master plan, design and construct a 2.91-acre neighborhood park at this undeveloped site in south Gresham. The project is located in the Gresham Butte Neighborhood District. SDC project #9.

**Justification:** Development is needed to provide a wide range of active and passive recreation opportunities for citizens at their nearby neighborhood park.

**Type of Project:** Master plan, design and construction of a neighborhood park for growth.

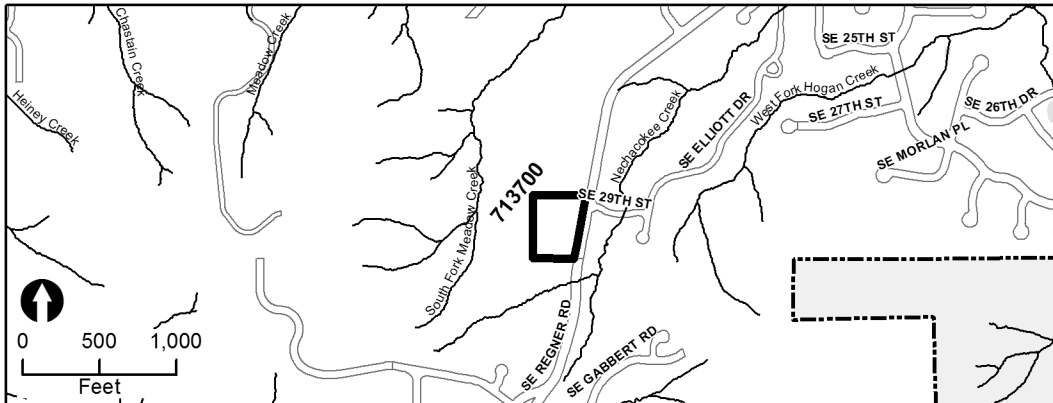

**Estimated Dollars:**

Funds	Description	Total
<b>Resources</b>	Other	1,812,665
	SDC	1,301,910
<b>Resources Total</b>		<b>3,114,575</b>
<b>Expenses</b>	Design/Const Admi	97,259
	Construction	2,634,824
	Admin (14%)	382,492
<b>Expenses Total</b>		<b>3,114,575</b>

**UNFUNDED and FUTURE PROJECT**  
**Parks, Trails, & Open Space**

**715800: East Gresham Neighborhood Park**

**Description:** This project will master plan, design, and construct a 5.53-acre neighborhood park in southeast Gresham. This project is located in the Powell Valley Neighborhood District. SDC project #10.

**Justification:** Development is needed to provide a wide range of active and passive recreation opportunities for citizens at their nearby neighborhood park.

**Type of Project:** Master plan, design and construction of a neighborhood park for growth.



**Estimated Dollars:**

Funds	Description	Total
Resources	Other	2,161,092
	SDC	1,552,160
Resources Total		3,713,252
Expenses	Design/Const Admi	129,679
	Construction	3,127,560
	Admin (14%)	456,013
Expenses Total		3,713,252



**UNFUNDED and FUTURE PROJECT**  
**Parks, Trails, & Open Space**

**722000: Southwest Community Park Master Plan**

**Description:** This project will master plan and design a 34.11-acre community park at this undeveloped site in southwest Gresham. The project is located in the Centennial Neighborhood District. This project is related to #705000. SDC project #5.

**Justification:** The master plan will identify park amenities and costs for the development of a wide range of active and passive recreation opportunities for all Gresham residents.

**Type of Project:** Master planning and design of a community park for growth.

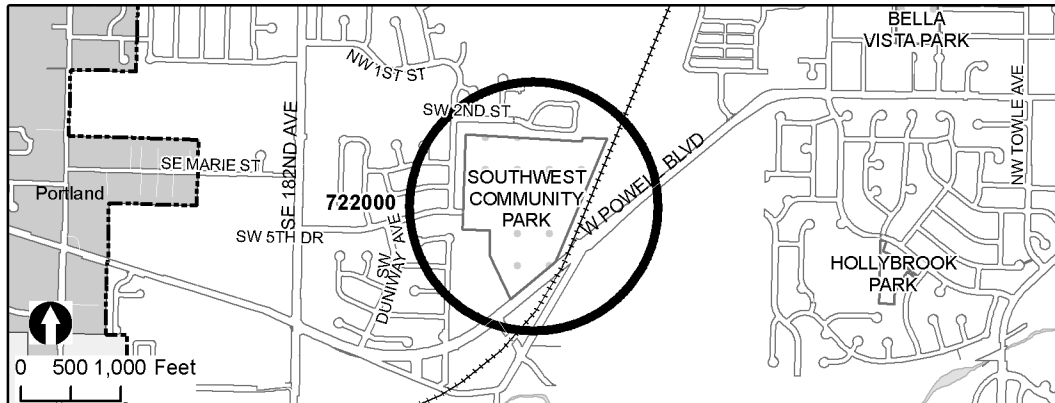

**Estimated Dollars:**

Funds	Description	Total
<b>Resources</b>	Other	61,987
	SDC	48,889
<b>Resources Total</b>		<b>110,876</b>
<b>Expenses</b>	Design/Const Admi	97,260
	Admin (14%)	13,616
<b>Expenses Total</b>		<b>110,876</b>

**UNFUNDED and FUTURE PROJECT**  
**Parks, Trails, & Open Space**

**722100: Southeast Neighborhood Park**

**Description:** This project will master plan, design and construct a 6.53-acre neighborhood park at this undeveloped site in southeast Gresham. The project is located in the Kelly Creek Neighborhood District. SDC project #14.

**Justification:** Development is needed to provide a wide range of active and passive recreation opportunities for citizens at their nearby neighborhood park.

**Type of Project:** Master plan, design and construction of a neighborhood park for growth.

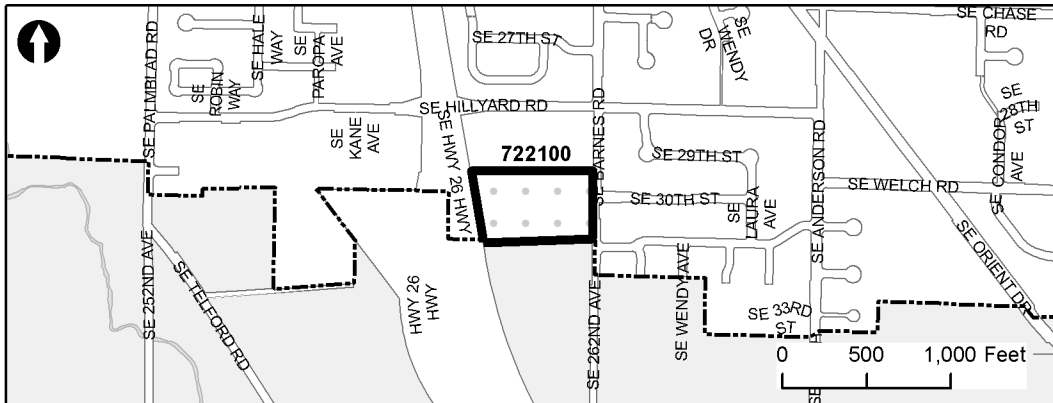

**Estimated Dollars:**

Funds	Description	Total
<b>Resources</b>	Other	2,539,580
	SDC	1,824,000
<b>Resources Total</b>		<b>4,363,580</b>
<b>Expenses</b>	Design/Const Admi	129,679
	Construction	3,698,022
	Admin (14%)	535,879
<b>Expenses Total</b>		<b>4,363,580</b>

**UNFUNDED and FUTURE PROJECT**  
**Parks, Trails, & Open Space**

**722200: Jenne Butte Neighborhood Park Master Plan**

**Description:** This project will master plan and design a 6.73-acre neighborhood park at this undeveloped site in southwest Gresham. The project is located in the Southwest Neighborhood District. This project is related to #722300. SDC project #15.

**Justification:** The master plan will identify park amenities and costs for the development of a wide range of active and passive recreation opportunities for citizens at their nearby neighborhood park.

**Type of Project:** Master planning and design of a neighborhood park for growth.

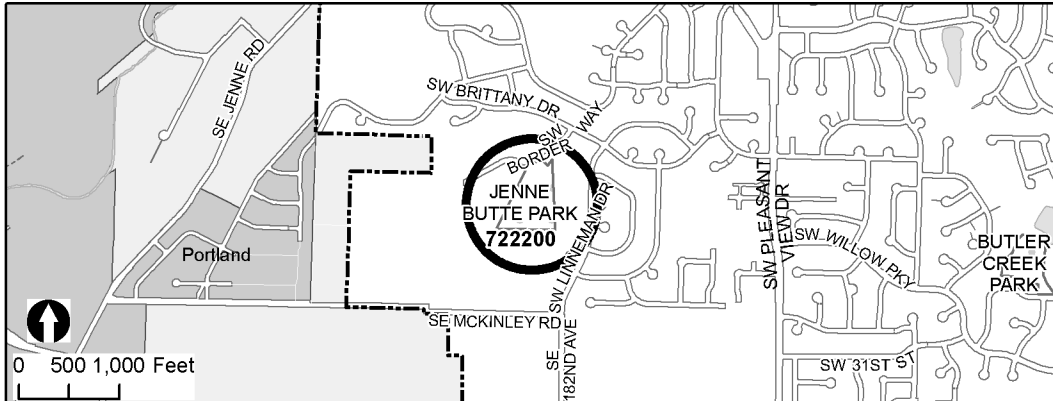

**Estimated Dollars:**

Funds	Description	Total
<b>Resources</b>	Other	35,234
	SDC	49,058
<b>Resources Total</b>		<b>84,292</b>
<b>Expenses</b>	Design/Const Admi	73,941
	Admin (14%)	10,351
<b>Expenses Total</b>		<b>84,292</b>

**UNFUNDED and FUTURE PROJECT**  
**Parks, Trails, & Open Space**

**722300: Jenne Butte Neighborhood Park Development**

**Description:** This project will construct a 6.73-acre neighborhood park at this undeveloped site in southwest Gresham. The project is located in the Southwest Neighborhood District. This project is related to #722200. SDC project #15.

**Justification:** Development is needed to provide a wide range of active and passive recreation opportunities for citizens at their nearby neighborhood park.

**Type of Project:** Construction of neighborhood park facilities for growth.

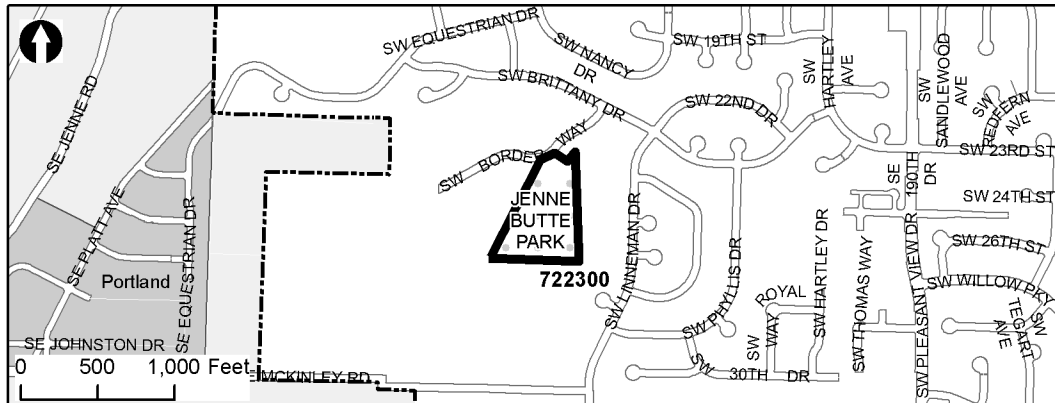

**Estimated Dollars:**

Funds	Description	Total
<b>Resources</b>	Other	2,579,534
	SDC	1,828,946
<b>Resources Total</b>		<b>4,408,480</b>
<b>Expenses</b>	Design/Const Admi	55,739
	Construction	3,811,348
	Admin (14%)	541,393
<b>Expenses Total</b>		<b>4,408,480</b>

**UNFUNDED and FUTURE PROJECT  
Parks, Trails, & Open Space**

**722400: Downtown Neighborhood Park #1**

**Description:** This project will acquire land, master plan, design and construct an up to 2-acre neighborhood park in the Downtown plan boundary. The project is located in the Central City Neighborhood District. SDC project #66.

**Justification:** Development is needed to provide a wide range of active and passive recreation opportunities for citizens at their nearby neighborhood park.

**Type of Project:** Acquisition, master plan, design and construction of a neighborhood park for growth.

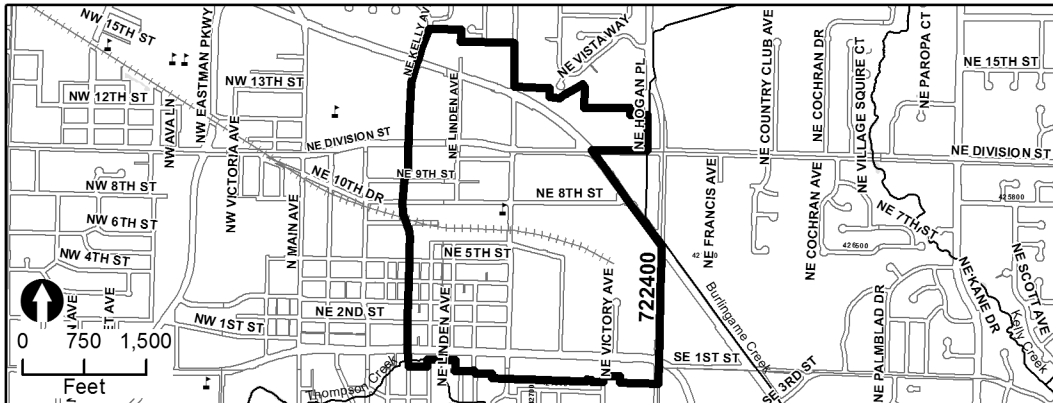

**Estimated Dollars:**

Funds	Description	Total
<b>Resources</b>	Other	1,264,163
	SDC	2,982,821
<b>Resources Total</b>		<b>4,246,984</b>
<b>Expenses</b>	Design/Const Admi	97,259
	Property Acq	2,074,863
	Construction	1,553,303
	Admin (14%)	521,559
<b>Expenses Total</b>		<b>4,246,984</b>

**UNFUNDED and FUTURE PROJECT**  
**Parks, Trails, & Open Space**

**722500: Gresham Paths**

**Description:** This project will acquire easements and/or right-of-ways, design and construct the following: 1) approximately 0.88 miles of off-road paths and associated infrastructure identified in the Gresham Trails Master Map adopted as Appendix J of the Parks and Recreation Trails and Natural Areas Master Plan; SDC project #43 and #77, and 2) approximately 0.38 miles of the incomplete Wy'East Path between NE 8<sup>th</sup> Street and NE Hogan Drive; SDC project #60.

**Justification:** Path and trail activities are the most popular form of recreation among park users in Gresham. This project provides opportunities for trail-related recreation; reduces auto-dependency by providing safe off-street, non-motorized neighborhood transportation connections; and connects to community open space.

**Type of Project:** Acquisition, design and construction of off-road paths for growth.



Estimated Dollars:	Funds	Description	Total
	Resources	Other	1,057,764
		SDC	1,410,582
	Resources Total		2,468,346
	Expenses	Design/Const Admi	380,142
		Property Acq	517,934
		Construction	1,267,139
		Admin (14%)	303,131
	Expenses Total		2,468,346

**UNFUNDED and FUTURE PROJECT  
Parks, Trails, & Open Space**

**722501 : Gresham Soft Trails**

**Description:** The project will acquire easements and/or right-of-ways, design and construct approximately 15.61 miles of soft surface trails and associated infrastructure identified in the Gresham Trails Master Map adopted as Appendix J of the Parks and Recreation Trails and Natural Areas Master Plan. This project does not include off-road paths in Gresham (see #722500) or soft trails in the Pleasant Valley or Springwater plan districts. SDC project #s: 40, 41, 45, 51, 52, 53, 78.

**Justification:** Path and trail activities are the most popular form of recreation among park users in Gresham. This project provides opportunities for trail-related recreation; reduces auto-dependency by providing safe off-street, non-motorized neighborhood transportation connections; and connects to community open space.

**Type of Project:** Acquisition, design and construction of soft surface trails for growth.



Estimated Dollars:	Funds	Description	Total
	Resources	Other	4,701,765
		SDC	6,270,047
	Resources Total		10,971,812
	Expenses	Design/Const Admi	2,133,158
		Property Acq	380,711
		Construction	7,110,527
		Admin (14%)	1,347,416
	Expenses Total		10,971,812

**UNFUNDED and FUTURE PROJECT**  
**Parks, Trails, & Open Space**

**722600: Rockwood Neighborhood Park**

**Description:** This project will acquire land, master plan, design and construct an approximately 2-acre neighborhood park in the Rockwood Plan District. SDC project #70.

**Justification:** Development is needed to provide a wide range of active and passive recreation opportunities for citizens at their nearby neighborhood park.

**Type of Project:** Acquisition, master plan, design and construction of a neighborhood park for growth.

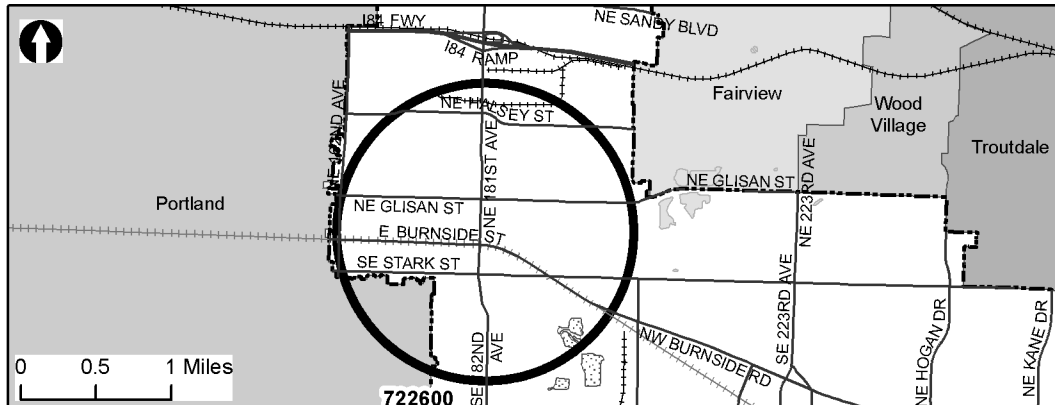

**Estimated Dollars:**

Funds	Description	Total
<b>Resources</b>	Other	1,264,163
	SDC	2,204,747
<b>Resources Total</b>		<b>3,468,910</b>
<b>Expenses</b>	Design/Const Admi	97,259
	Property Acq	1,137,534
	Construction	1,808,111
	Admin (14%)	426,006
<b>Expenses Total</b>		<b>3,468,910</b>



**UNFUNDED and FUTURE PROJECT**  
**Parks, Trails, & Open Space**

**722700: Pat Pfiefer Park Irrigation**

**Description:** This project will install irrigation to serve the last two non-irrigated fields in the park. The project is located in the Rockwood Neighborhood District. This will increase playability and enhance the level of service for the user groups.

**Justification:** Complete the irrigation system at Pat Pfiefer Park.

**Type of Project:** Design and Construction

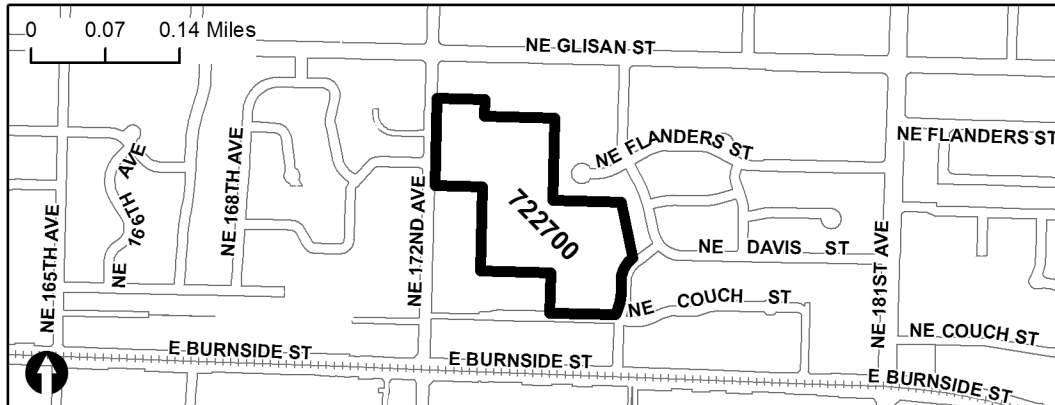

**Estimated Dollars:**

Funds	Description	Total
Resources	Grant	50,000
<b>Resources Total</b>		<b>50,000</b>
Expenses	Design/Const Admin	15,000
	Construction	28,860
	Admin (14%)	6,140
<b>Expenses Total</b>		<b>50,000</b>

**UNFUNDED and FUTURE PROJECT**  
**Parks, Trails, & Open Space**

**723300: Skate Park Future Phases**

**Description:** This project will construct additional improvements to the Skate Park. These improvements are broken into two phases. The first phase is additional skating features, ramps and bowls. The second phase is a fabric cover for the skate park. The project is located in the Central City Neighborhood District.

**Justification:** Provide recreational amenities for all community members.

**Type of Project:** Construct additional park improvements at an existing community park.



**Estimated Dollars:**

Funds	Description	Total
Resources	Other	2,280,000
<b>Resources Total</b>		<b>2,280,000</b>
Expenses	Design/Const Admin	400,000
	Construction	1,600,000
	Admin (14%)	280,000
<b>Expenses Total</b>		<b>2,280,000</b>

**UNFUNDED and FUTURE PROJECT**  
**Parks, Trails, & Open Space**

**723400: Sports Park Development**

**Description:** This project will complete the construction at the Gradin Community Sports Park in south Gresham. This includes the building of the community center, skate park, sports fields and all other elements associated with the Master Plan. The project is located in the Mt. Hood Neighborhood District. This project is related to #CIPPK00001. SDC project #20.

**Justification:** This multi-use facility is needed to help meet the recreation facility and service needs of the community.

**Type of Project:** Construction of additional community park improvements for growth.

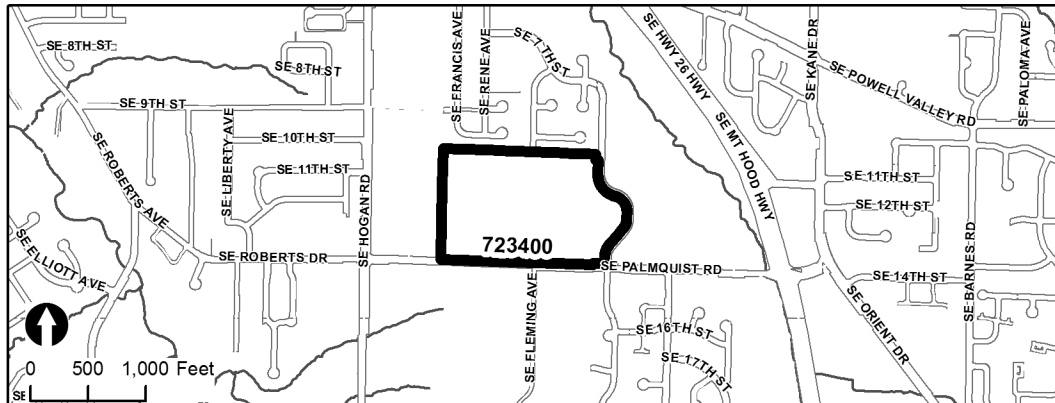

**Estimated Dollars:**

Funds	Description	Total
Resources	Other	19,207,265
	SDC	15,118,992
Resources Total		34,326,257
Expenses	Design/Const Admi	2,701,871
	Construction	27,408,880
	Admin (14%)	4,215,506
Expenses Total		34,326,257

**UNFUNDED and FUTURE PROJECT**  
**Parks, Trails, & Open Space**

**723500: Arts Center**

**Description:** This project will enhance the Arts Center to provide more positive recreational activities, visual interest and increase park usage. The Arts Center site is evolving into a destination for Downtown Gresham. The inter-active fountain has been designed for safety, aesthetics, sustainability, cost and theme. The fountain compliments the existing colored pavement lights and recent art pillar installations. The project is located in the Central City Neighborhood District.

**Justification:** The center will provide customer service by helping meet the program needs of seniors, adults, teens, school-age, pre-school, families with disabilities, and diverse cultural groups. The center will also help direct the city's youth toward positive activities. Development is needed to provide a wide range of recreation opportunities for all Gresham residents.

**Type of Project:** Construction of facilities and utilities for growth.

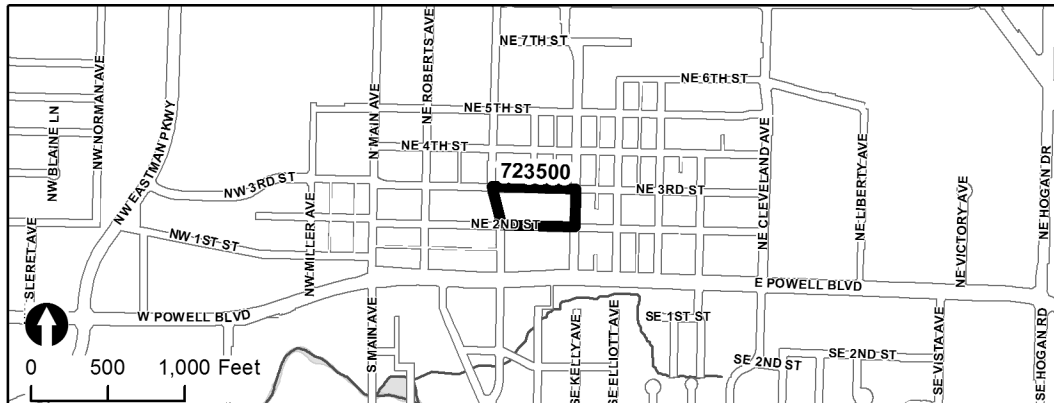

**Estimated Dollars:**

Funds	Description	Total
Resources	Other	16,480,000
<b>Resources Total</b>		<b>16,480,000</b>
Expenses	Design/Const Admin	1,648,000
	Construction	12,524,800
	Admin (14%)	2,307,200
<b>Expenses Total</b>		<b>16,480,000</b>

**UNFUNDED and FUTURE PROJECT**  
**Parks, Trails, & Open Space**

**723600: SE Community Park Development**

**Description:** This project will construct recreation facilities identified in the master plan for the 16.13-acre undeveloped community park in southeast Gresham. The project is located in the Kelly Creek Neighborhood District. The project is related to #703200. SDC project #4.

**Justification:** Development of this community park is needed to provide a wide range of active and passive recreation opportunities for all Gresham residents.

**Type of Project:** Construction of facilities and utilities for growth.

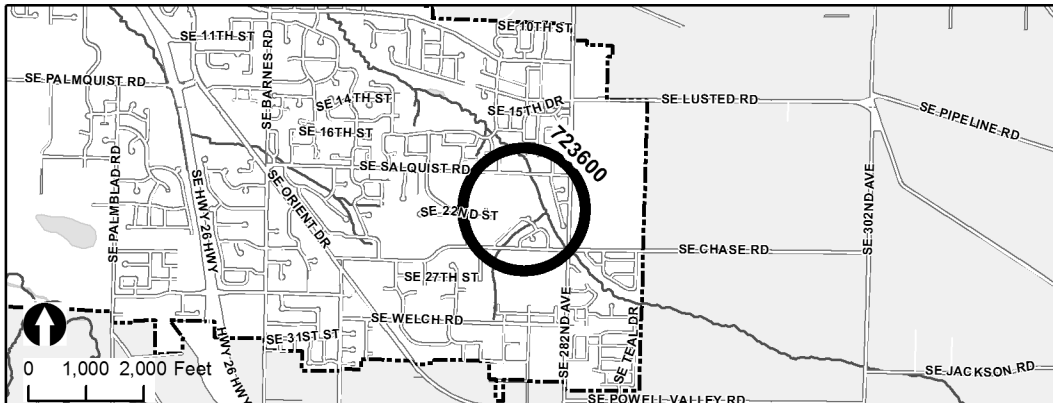

**Estimated Dollars:**

Funds	Description	Total
Resources	Other	5,331,399
	SDC	4,196,539
Resources Total		9,527,938
Expenses	Design/Const Admi	326,066
	Construction	8,031,774
	Admin (14%)	1,170,098
Expenses Total		9,527,938

**UNFUNDED and FUTURE PROJECT**  
**Parks, Trails, & Open Space**

**723700: Main City Park Improvements Future**

**Description:** This project will renovate and enhance Main City Park to accommodate community-wide events. Due to the park location as a designated regional town center and relationship with the regional Springwater Trail, Main City Park is being repositioned to become the flagship community park of Gresham. The central core of the park will be reconfigured, removing parking with replacement of a focal-point Destination Playground. The playground will be designed for safety, aesthetics, inclusivity, accessibility, cost and theme. The Destination Playground will include play elements for children 2-5, 5- 12 and a decorative, inter-active water feature. There is an additional resource need to complete the plan improvements that will also include an improved group picnic area; renovated ball fields, basketball courts, and horseshoe pits; bocche and croquet fields; entry plaza; off-lease dog park; amphitheater; meadows and environmental enhancement of Johnson Creek. Main City Park is located in the Central City and Gresham Butte Neighborhood Districts. SDC project #67.

**Justification:** Development is needed to provide a wider range of recreation opportunities for all Gresham residents.

**Type of Project:** Expansion of community park facilities for growth.

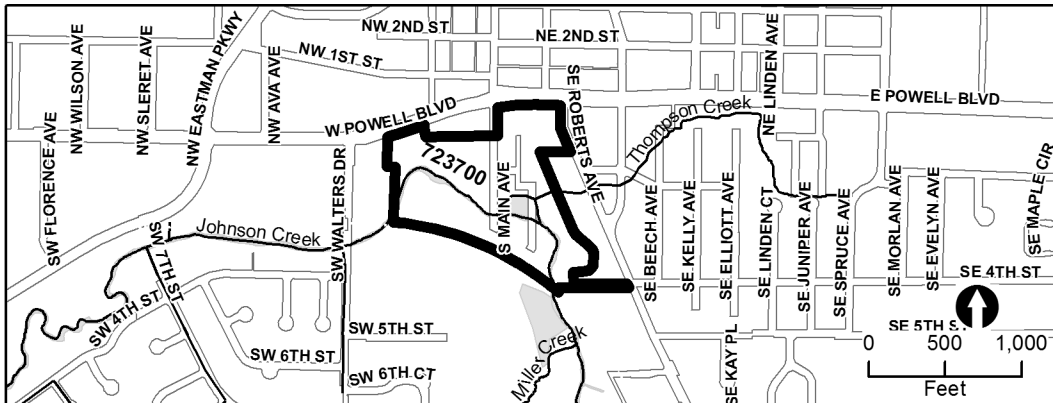

**Estimated Dollars:**

Funds	Description	Total
<b>Resources</b>	Other	9,104,405
	SDC	614,010
<b>Resources Total</b>		<b>9,718,415</b>
<b>Expenses</b>	Design/Const Admi	742,840
	Construction	7,782,086
	Admin (14%)	1,193,489
<b>Expenses Total</b>		<b>9,718,415</b>

**UNFUNDED and FUTURE PROJECT**  
**Parks, Trails, & Open Space**

**723800: Hogan Butte Nature Park Development – Phase 2**

**Description:** This project will design and construct the second phase of the 52.02-acre nature park and viewpoint in south Gresham in keeping with the 2008 Hogan Butte Nature Park Master Plan. The project is located in the Gresham Butte Neighborhood District. SDC project #3.

**Justification:** The project provides passive recreation facilities for the community to view five Cascade Mountains and to learn why park and open space land needs to be acquired and preserved/protected or developed to provide recreation opportunities for the community.

**Type of Project:** Design and construction of community park facilities for growth.

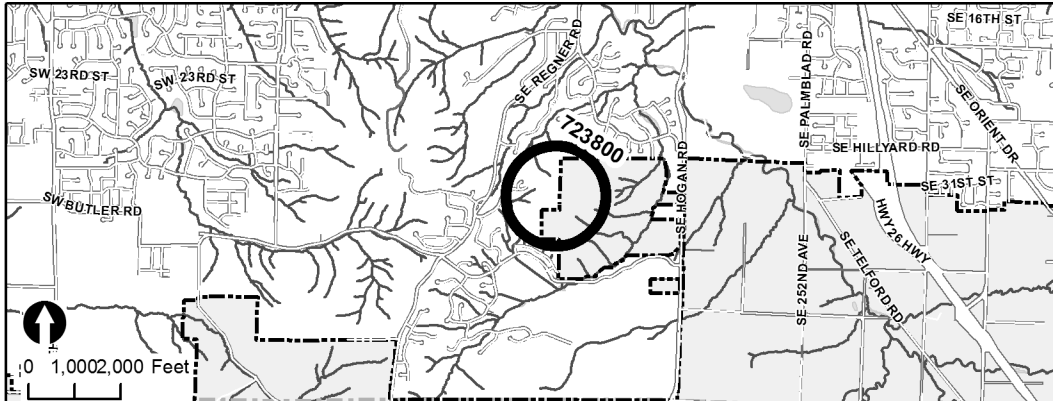

Estimated Dollars:

Funds	Description	Total
Resources	Other	2,433,938
	SDC	1,456,490
Resources Total		3,890,428
Expenses	Design/Const Admi	631,413
	Construction	2,781,243
	Admin (14%)	477,772
Expenses Total		3,890,428

**UNFUNDED and FUTURE PROJECT**  
**Parks, Trails, & Open Space**

**724800: Nadaka Nature Park**

**Description:** This project will design and construct a new or expanded children's play area and affiliated improvements. The project is located in the Wilkes East Neighborhood District. SDC project #73.

**Justification:** Expansion of this park is needed to provide a wide range of active and passive recreation opportunities for citizens at their nearby neighborhood park.

**Type of Project:** Design and construction of neighborhood park facilities for growth.

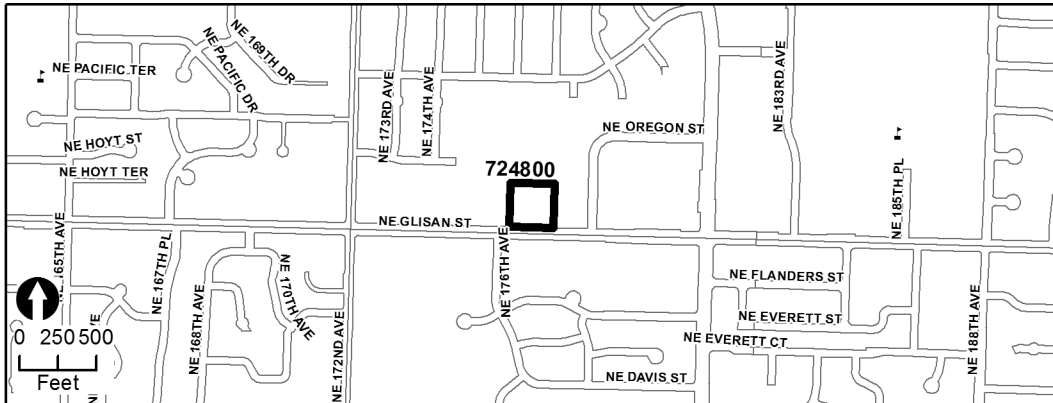

**Estimated Dollars:**

Funds	Description	Total
<b>Resources</b>	Other	22,642
	SDC	16,262
<b>Resources Total</b>		<b>38,904</b>
<b>Expenses</b>	Design/Const Admi	12,968
	Construction	21,159
	Admin (14%)	4,777
<b>Expenses Total</b>		<b>38,904</b>



**UNFUNDED and FUTURE PROJECT**  
**Parks, Trails, & Open Space**

**724900: Columbia View Neighborhood Park**

**Description:** This project will design and construct a 7.46-acre neighborhood park at this unimproved site. The master plan for this park was adopted in 1988 and will likely need to be modified to meet the desires of the surrounding neighborhood. The project is located in the Wilkes East Neighborhood District. This project is related to #711200. SDC project #69.

**Justification:** Development is needed to provide a wide range of active and passive recreation opportunities for citizens at their nearby neighborhood park.

**Type of Project:** Design and construction of neighborhood park facilities for growth.

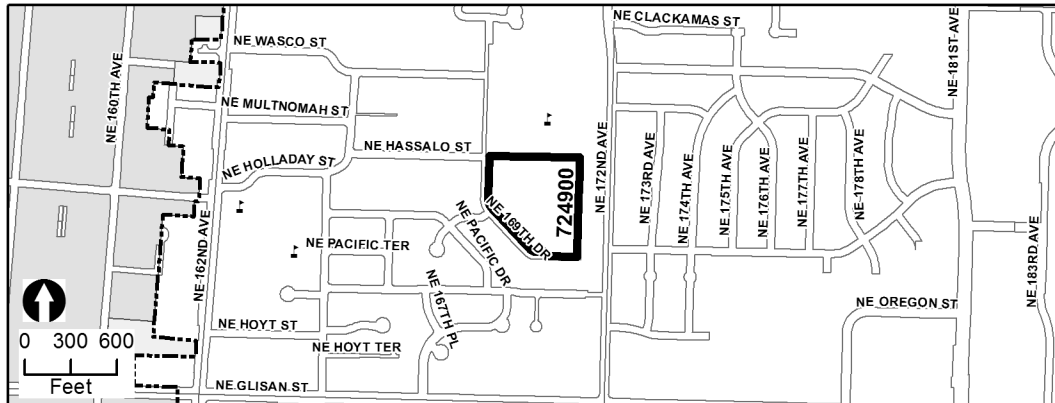

**Estimated Dollars:**

Funds	Description	Total
<b>Resources</b>	Other	2,888,931
	SDC	2,074,916
<b>Resources Total</b>		<b>4,963,847</b>
<b>Expenses</b>	Design/Const Admi	129,679
	Construction	4,224,573
	Admin (14%)	609,595
<b>Expenses Total</b>		<b>4,963,847</b>

**UNFUNDED and FUTURE PROJECT**  
**Parks, Trails, & Open Space**

**725000: Civic Neighborhood Park Phase 2**

**Description:** This project constructs the second phase of the approximately 2-acre neighborhood park in the Civic Neighborhood Plan Area. The project is located in the Northwest Neighborhood District. This project is related to # CIPPK00005 and #CIPPK00008.

**Justification:** Development is needed to provide a wide range of active and passive recreation opportunities for citizens at their nearby neighborhood park.

**Type of Project:** Construction of neighborhood park facilities for growth.

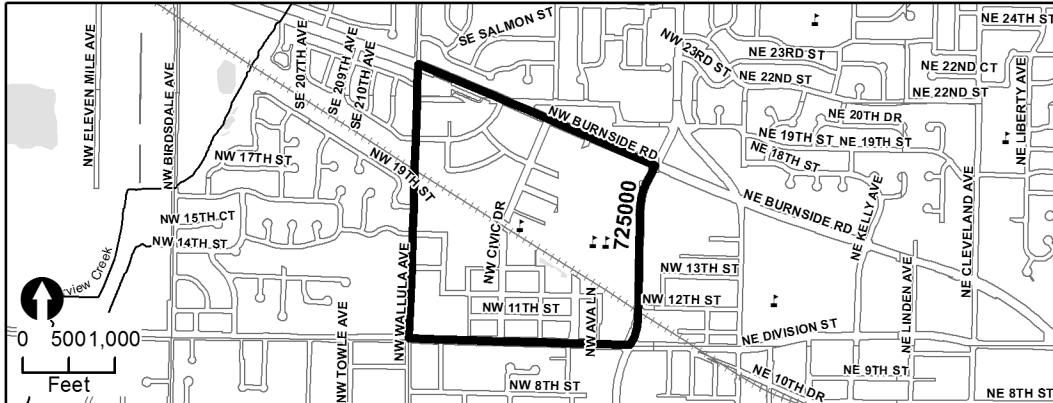

**Estimated Dollars:**

Funds	Description	Total
<b>Resources</b>	Other	1,264,163
	SDC	2,982,821
<b>Resources Total</b>		<b>4,246,984</b>
<b>Expenses</b>	Design/Const Admi	97,259
	Property Acq	2,074,862
	Construction	1,553,304
	Admin (14%)	521,559
<b>Expenses Total</b>		<b>4,246,984</b>

**UNFUNDED and FUTURE PROJECT**  
**Parks, Trails, & Open Space**

**725100: Rockwood Soccer/Futsal Courts**

**Description:** This project will design and construct soccer or futsal courts in City park or open space land in the Rockwood Plan District. SDC project #74.

**Justification:** Development is needed to provide a wide range of active and passive recreation opportunities for citizens.

**Type of Project:** Design and construction of park facilities for growth.

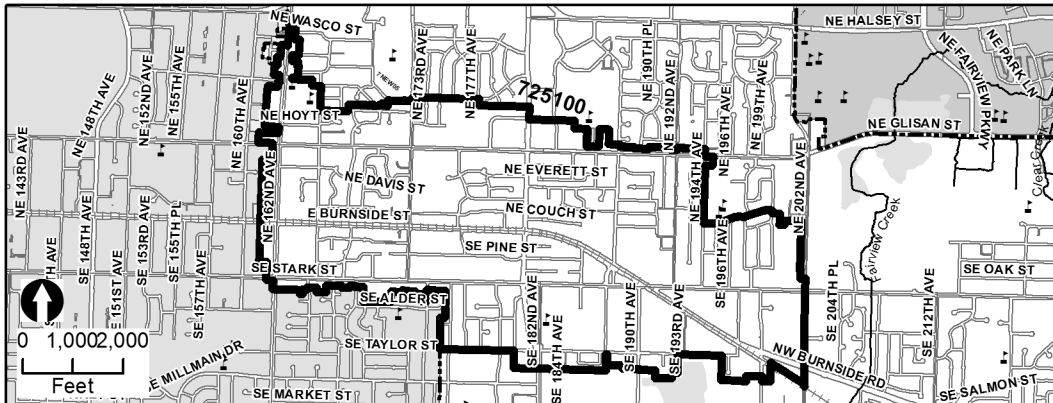

**Estimated Dollars:**

Funds	Description	Total
Resources	Other	120,756
	SDC	86,731
Resources Total		207,487
Expenses	Design/Const Admi	12,968
	Construction	169,037
	Admin (14%)	25,482
Expenses Total		207,487

**UNFUNDED and FUTURE PROJECT**  
**Parks, Trails, & Open Space**

**725200: Downtown Neighborhood Park #2 - East**

**Description:** This project will acquire land, master plan, design and construct an approximately 2-acre neighborhood park in the Downtown boundary east of Kelly Avenue. This project is located in the Central City Neighborhood District. SDC project #16.

**Justification:** Development is needed to provide a wide range of active and passive recreation opportunities for citizens at their nearby neighborhood park.

**Type of Project:** Acquisition, master plan, design and construction of a neighborhood park for growth.

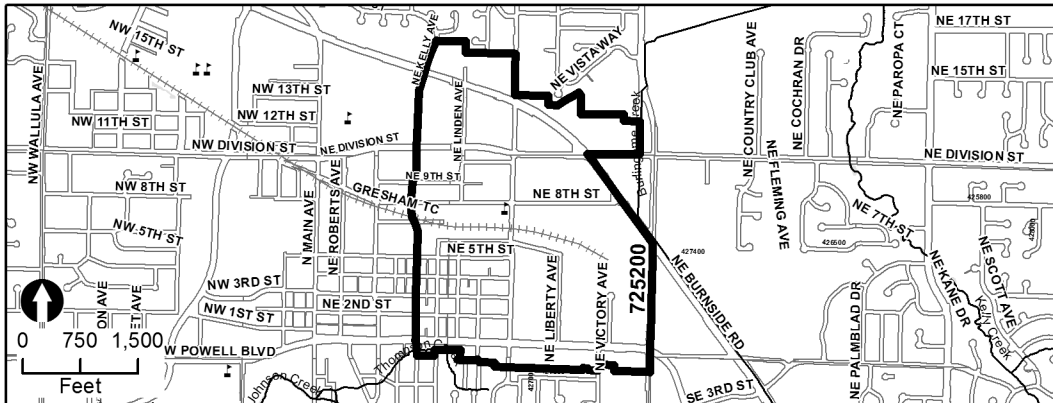

Estimated Dollars:

Funds	Description	Total
Resources	Other	1,264,163
	SDC	2,982,821
Resources Total		4,246,984
Expenses	Design/Const Admi	97,259
	Property Acq	2,074,862
	Construction	1,553,304
	Admin (14%)	521,559
Expenses Total		4,246,984

**UNFUNDED and FUTURE PROJECT**  
**Parks, Trails, & Open Space**

**CIPPK00002: Vance Neighborhood Park**

**Description:** This project will design and construct a parking area and associated improvements within Vance Neighborhood Park, currently owned by Multnomah County. This project is located in the Rockwood Neighborhood. SDC project #75.

**Justification:** Addition of a parking lot would make it more convenient and safer for residents to access this neighborhood park.

**Type of project:** Design and construction of additional neighborhood park facilities for growth.

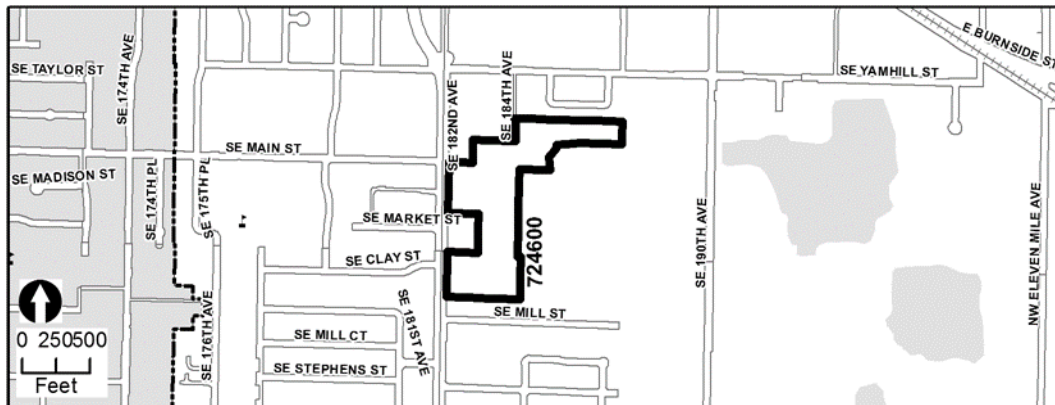

**Estimated Dollars:**

Funds	Description	Total
<b>Resources</b>	Other	415,098
	SDC	298,136
<b>Resources Total</b>		<b>713,234</b>
<b>Expenses</b>	Design/Const Admi	142,647
	Construction	483,054
	Admin (14%)	87,533
<b>Expenses Total</b>		<b>713,234</b>

**UNFUNDED and FUTURE PROJECT**  
**Parks, Trails, & Open Space**

**CIPPK00005: Civic Neighborhood Development - 1996 Agreement**

**Description:** This project reflects the City's potential obligation as described in the 1996 Gresham Civic Neighborhood Financing Agreement (City Agreement 1996-083) to reimburse a developer for construction of park infrastructure related to the Civic Neighborhood Project. The project is located in the Northwest Neighborhood District. SDC project #76.

**Justification:** City financial support is needed to support the innovative objectives of the Civic Neighborhood Development Plan.

**Type of project:** Construction of utilities and facilities for growth.

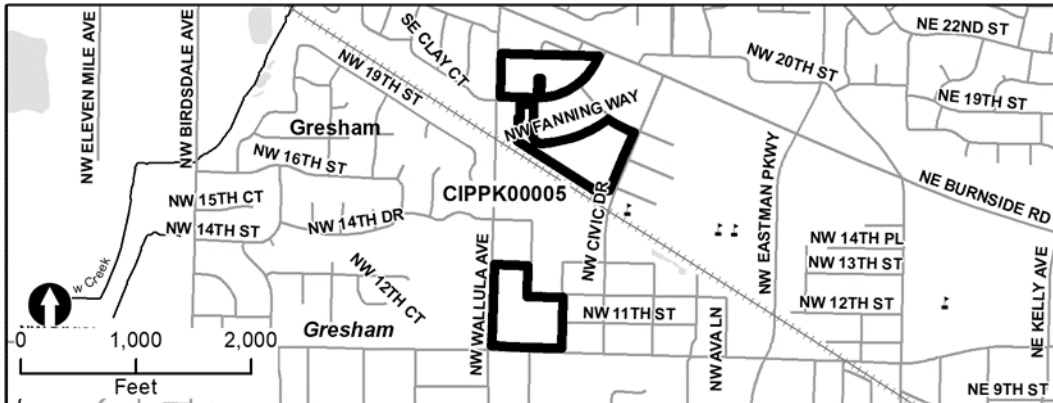

**Estimated Dollars:**

Funds	Description	Total
Resources	SDC	799,700
<b>Resources Total</b>		<b>799,700</b>
Expenses	Construct/Reimburse	799,700
<b>Expenses Total</b>		<b>799,700</b>